

Mirror Door Systems Ltd

Unit 6, Capitol Industrial Centre, Fulmar Way, Wickford, Essex SS11 8YW, UK
 Telephone: +44 (0) 1268 573357 · Facsimile: +44 (0) 1268 573358
 www.mirrordoor.co.uk · Email: salesmds@mirrordoor.co.uk



PEARL

ALUMINIUM WARDROBE SYSTEM FIXING INSTRUCTIONS

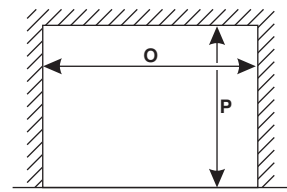
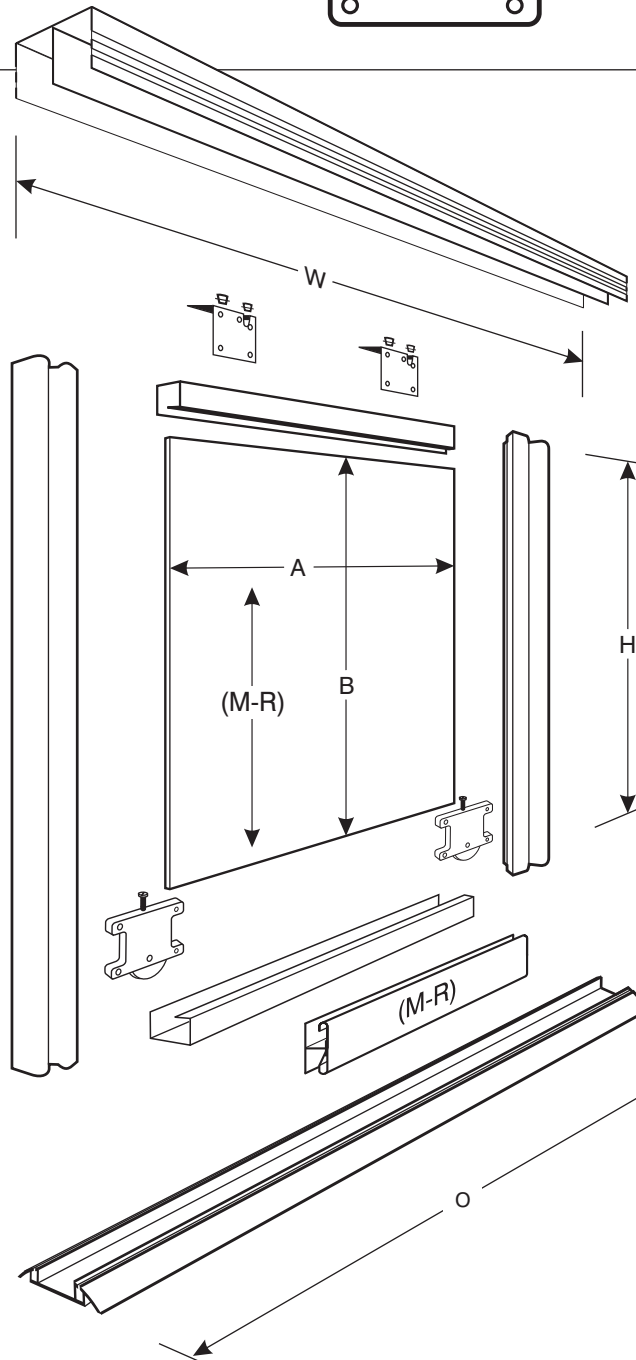
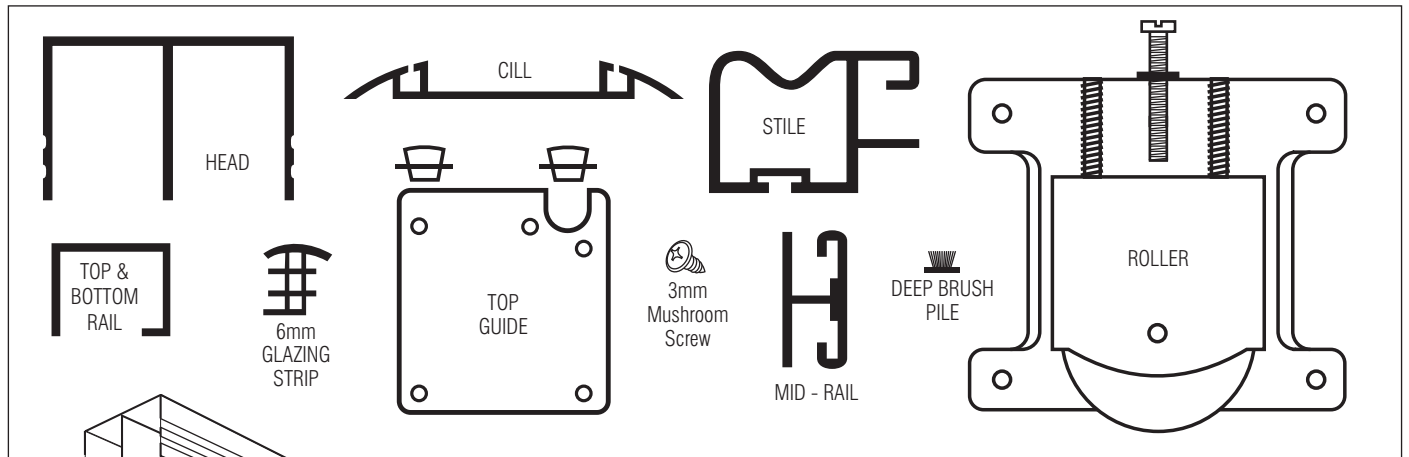

H	P - 30mm	P - 30mm	P - 30mm
W	$\frac{(O + 35mm)}{2}$	$\frac{(O + 70mm)}{3}$	$\frac{(O + 70mm)}{4}$
A	W - 46mm	W - 46mm	W - 46mm
B	P - 34mm	P - 34mm	P - 34mm
O	Opening Width	Opening Width	Opening Width
P	Opening Height	Opening Height	Opening Height

COMPONENTS - GENERAL DIMENSIONS & DETAIL

- HEAD: 77mm width x 41mm high
- CILL: >60mm width x 6mm high
- RAIL: 15mm width x 15mm high (2 per door)
- STILE: 34mm width x 28mm high/10mm opening (2 per door)
- TOP GUIDE: 55mm width x 62mm high x 14mm lip (2 per door)
- ROLLER: 100mm width x 80mm high (2 per door)
- Casing - Steel · Wheel - Nylon · Weight Capacity - 60 kg
- SCREW MUSHROOM: 3mm (12 per door)
- GLAZING STRIP: 6mm (to suit size)
- BRUSH PILE: 2mm (to suit size)
- MID-RAIL: 15mm width x 25mm high x 2mm Mid Bar thick

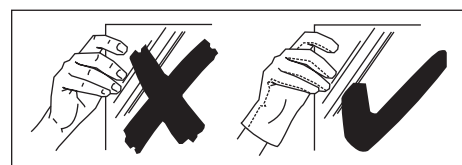

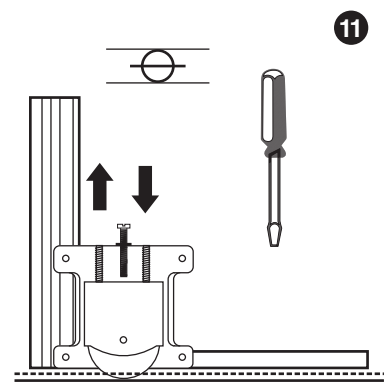
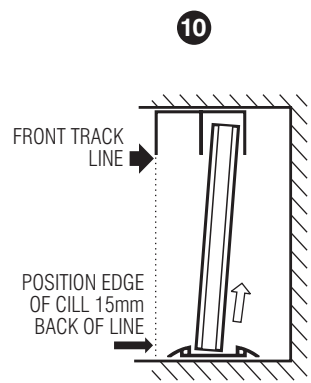
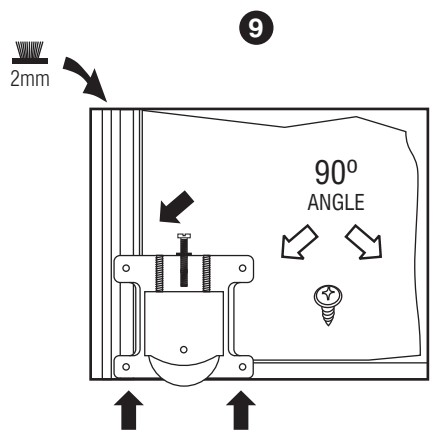
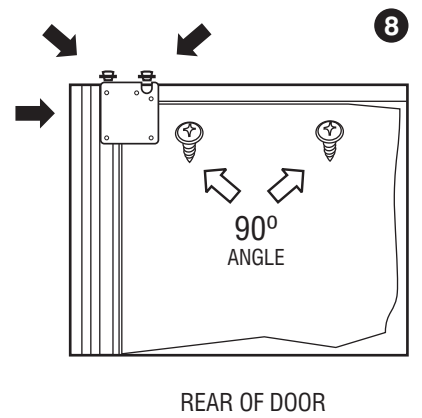
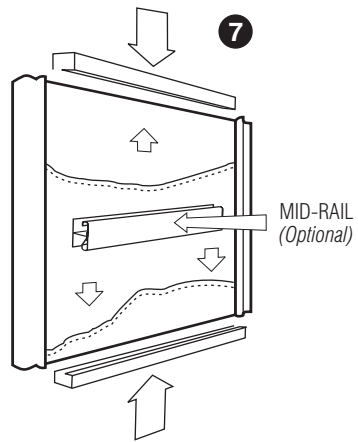
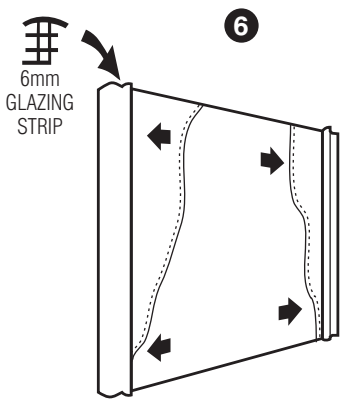
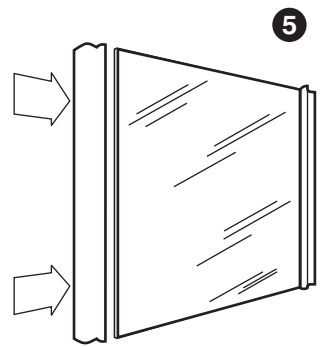
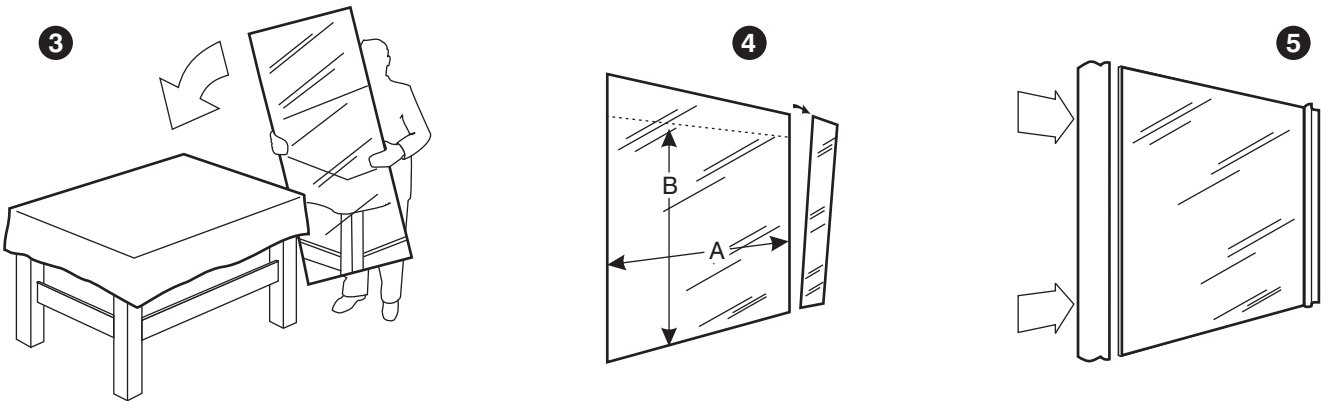
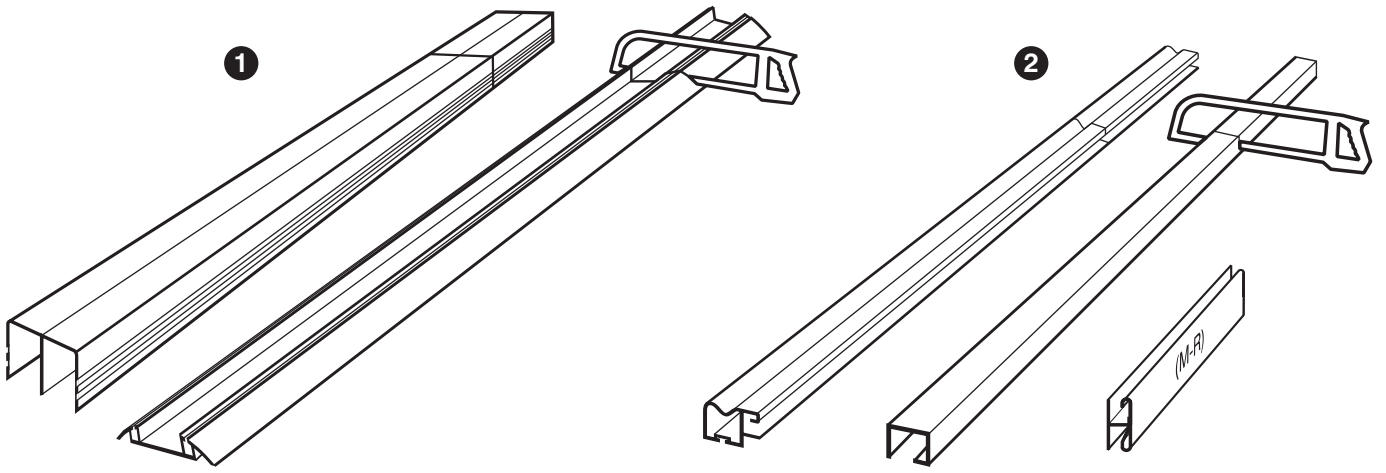

NB • When installing top guides and bottom rollers, apply nominal pressure in order not to touch the glass mirror.