

Mirror Door Systems Ltd

Unit 6, Capitol Industrial Centre, Fulmar Way, Wickford, Essex SS11 8YW, UK
 Telephone: +44 (0) 1268 573357 · Facsimile: +44 (0) 1268 573358
 www.mirrordoor.co.uk · Email: salesmlds@mirrordoor.co.uk



TUSCANY

ALUMINIUM WARDROBE SYSTEM FIXING INSTRUCTIONS

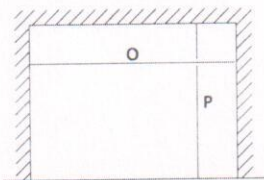
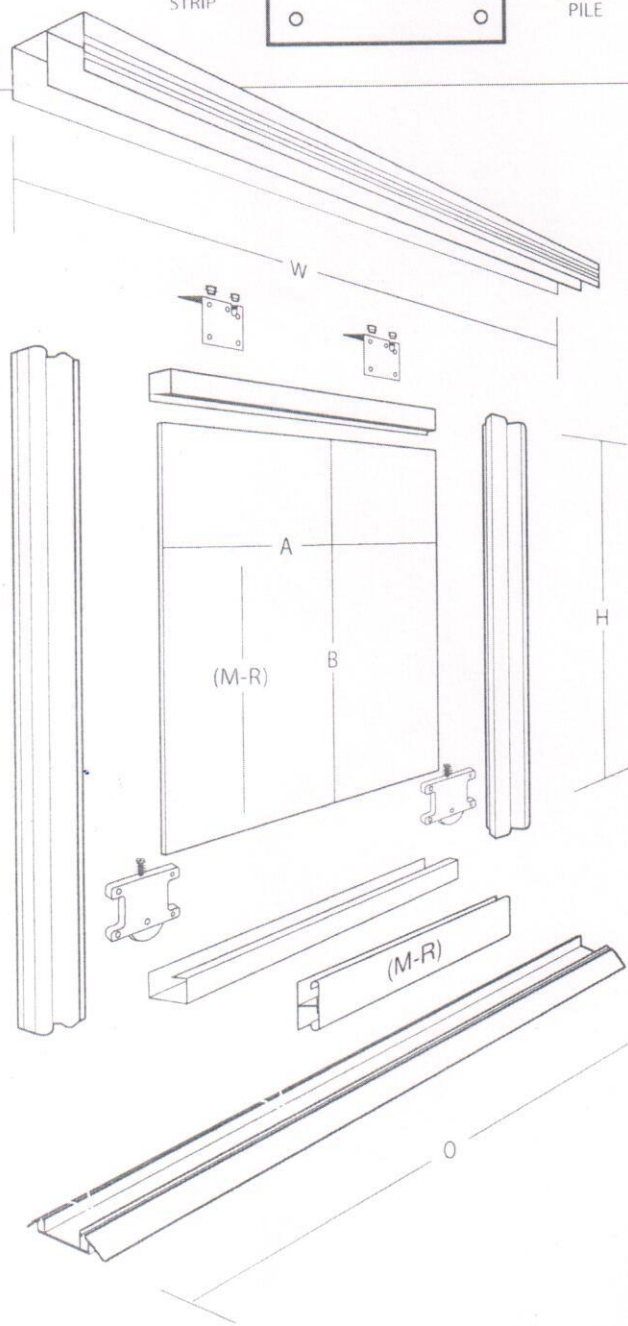
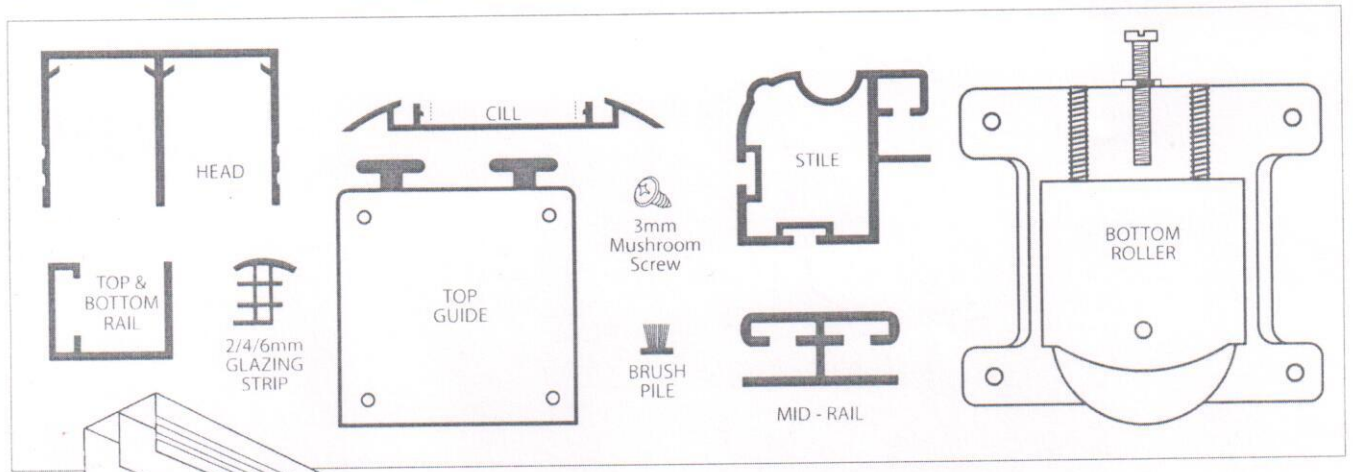

H	P - 40mm	P - 40mm	P - 40mm
W	$\frac{(O + 38mm)}{2}$	$\frac{(O + 76mm)}{3}$	$\frac{(O + 76mm)}{4}$
A	W - 52mm	W - 52mm	W - 52mm
B	P - 44mm	P - 44mm	P - 44mm
O	Opening Width	Opening Width	Opening Width
P	Opening Height	Opening Height	Opening Height

- COMPONENTS - GENERAL DIMENSIONS & DETAIL**
 HEAD: 80mm width x 40mm high
 CILL: 63mm width x 9mm high
 RAIL: 16mm width x 12mm high (2 per door)
 STILE: 38mm width x 31mm depth / 10mm opening
 TOP GUIDE: 45mm width x 38mm high (Bearing Rollers)
 Btm ROLLER: 99mm width x 75mm high
 Casing - Steel · Wheel - Nylon · Weight Capacity - 50 kg
 SCREW: Mushroom head 3mm (12 per door)
 GLAZING STRIP: 2/4/6mm (to suit size)
 BRUSH PILE: 2mm (to suit size)
 MID-RAIL: 15mm width x 25mm high x 2mm thick

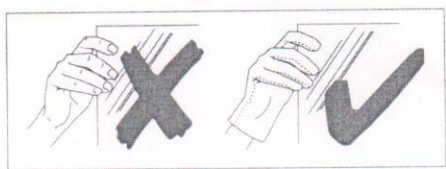

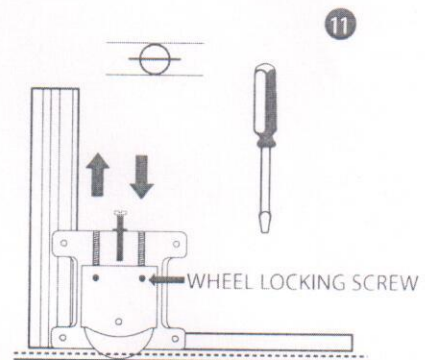
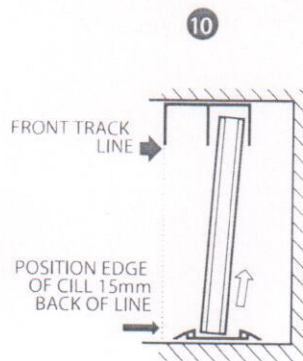
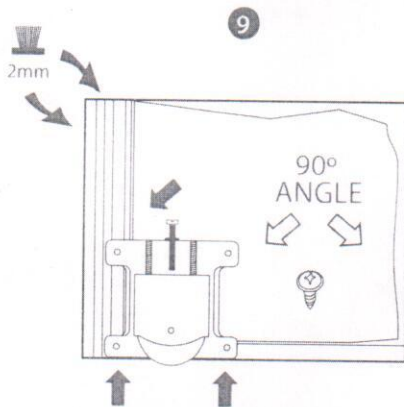
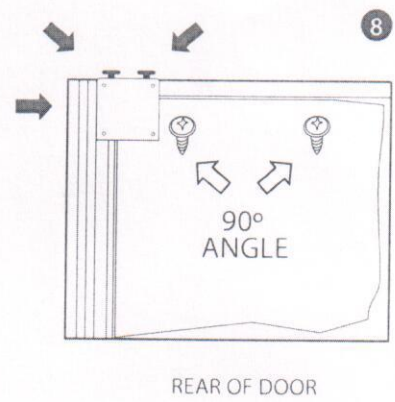
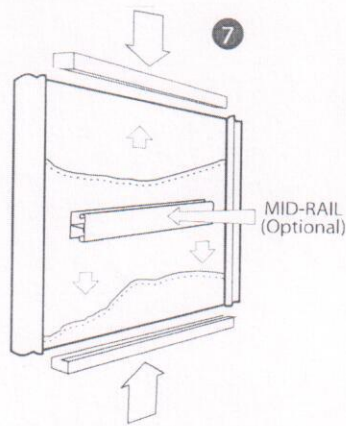
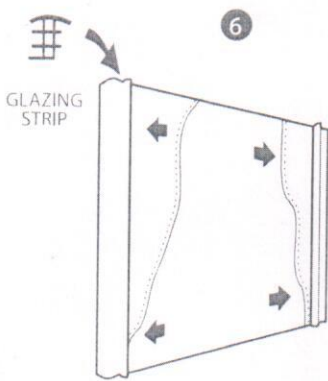
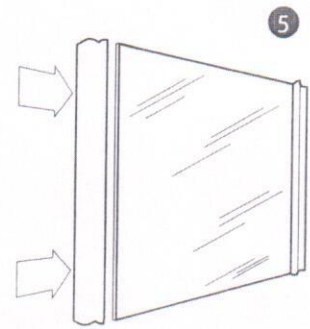
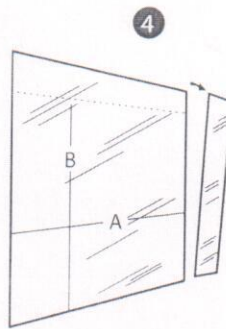
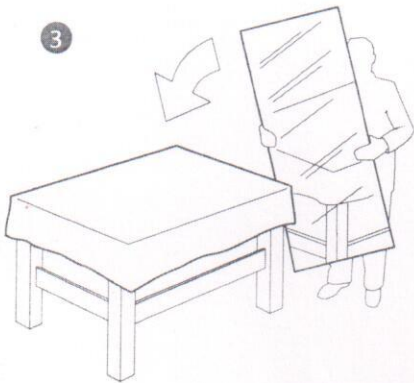
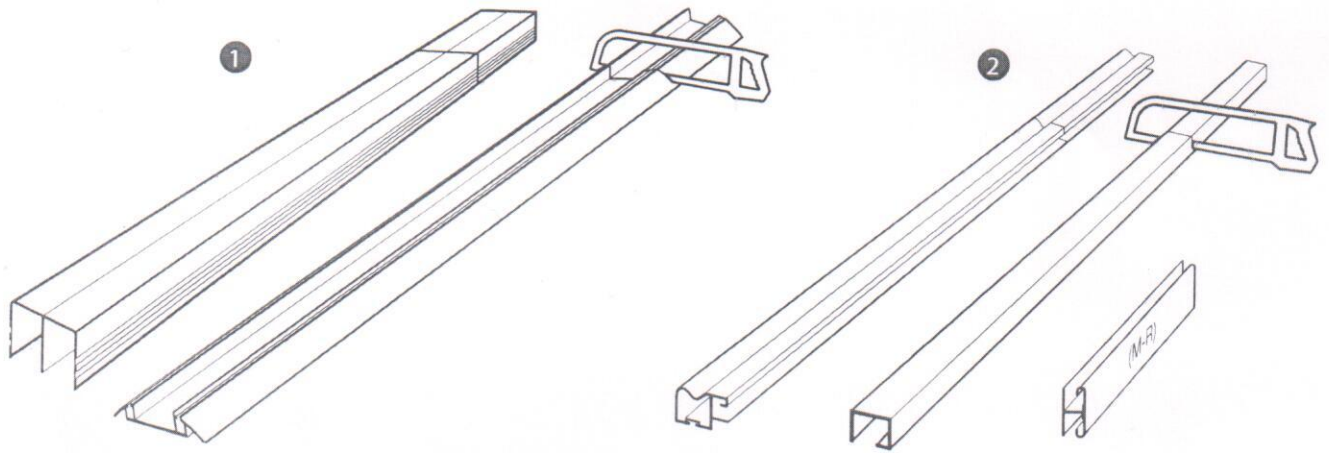

NB • When installing top guides and bottom rollers, apply nominal pressure in order not to touch the glass mirror